



**UNIVERSAL
ORBITAL
SYSTEMS
PVT. LTD.**
AN ISO 9001 : 2015 CERTIFIED COMPANY

The Complete Orbital Welding Solution



**ORBITRON 8000 With CA-25X
Micro Weld Head Series**

Compact Orbital Welding GTAW Power Source ORBITRON-8000

Features

- ◆ Auto Programming Mode Generates Welds Procedures Automatically.
- ◆ Stores 800 Programs 400 Auto And 400 Manuals Programs.
- ◆ Manual Programs Can Be Stores With Tags.
- ◆ Compact ,Rugged, noise Proof Design, Weighing Only 23 Kg.
- ◆ User Friendly For All Operators.
- ◆ A Simple Design, Easy To Understanding For All Operators.
- ◆ Segment Wise Programming With Degree Positional Reference.
- ◆ In Built Weld Data Logger With USB Port
- ◆ Auto Fault Detection Detects “ Arc Fault” “Rotor Jam”
“Earth Fault” “Gas Fault” And User Guidance To Fix The Fault.
- ◆ Suitable For All UNIVERSAL Weld Heads Including Tube To Tube
And Tube To Tube Sheet.
- ◆ Password Protected Key Function For User Levels Such As Welder, Supervisor, Admin.
- ◆ Auto Tacking Facility.
- ◆ Specially Tuned GTAW Power Source With Highly Stable Current For Orbital Welding.
- ◆ Separate Compact Water Cooling Unit For Weld Head Cooling.
- ◆ IoT Connected Power Source.
- ◆ You Can See Machine Status UOSPL App And Web Portal.
Continuously From Your Pc / Mobile (Android / IOS) For ORBITRON 8000.
- ◆ 10 Inch Screen Combines A Large, High- Resolution Display With
An Ultra- Intuitive Interface.
- ◆ Advanced Shielding Gas Flow Control System Enabling Precise
Optimization Of Gas Flow For Improved
Welding Performance And Quality.
- ◆ Qr Code Scanner For Welder I.D. / Job I.D.
- ◆ Welding Current Change Is Possible While Welding Modifying Welding Current
During Welding Precess Is Possible And Modified Parameters Will Be Accordingly.
- ◆ Auto Purge Control Unit For Optimizing Purging Gas Flow To Enhance Weld Quality.
- ◆ Step Programming Available.

Printout



PROJECT DONE BY:
UNIVERSAL ORBITAL
CLIENT NAME:
SUPREME ALLIED
OPERATOR NAME:
SURAJ
HEAD TYPE:
CA-2SR
CONTROLLER TYPE:
ORBITRON-8000
MACHINE SP. NO.: 240806
DATE:22/8/2024
TIME:12:22:13
WELD NO.:A 37
TUBE THICK(MM):1.0
TUBE DIA(MM):12.7
PREHEAT(S):1.5
POST GAS(S):30.0
PRE GAS(S):30.0
HIGH PULSE(S):0.20
LOW PULSE(S):0.20
BASE CURRENT(A):18

LEVEL NO.	TRAVEL DEG	SPEED %	CURRENT (A)
A	0	50	30
B	90	50	28
C	180	50	28
D	230	50	28
E	270	50	28
F	300	50	28
G	330	50	27
H	360	50	28
I	390	55	25

APPROVED BY:



Orbital Welding Closed Arc Micro Weld Head Series MH-12 / MH-16X / MH-25X

Features

- ◆ Micro Head Series
- ◆ Detachable Clamping Systems
- ◆ Compact Design To Permit Use In Constricted Work Space
- ◆ Shielded-gas Chamber To Prevent Od Discoloration
- ◆ Quick Change Collects Systems
- ◆ Welding On Exact Position
- ◆ Modular Design Facilitates A Rang Of Fixture.
- ◆ Dc Motor With Encoder For The Weld Head
- ◆ Light In Weight
- ◆ Fixture Block Includes Centering Gauge



MH-12



MH-25X

Technical Specifications

Description	UNIT	MH-12	MH-16X	MH-25X
Diameter Of Work Piece	MM	3.14 TO 12.7	3.14 To 15.8	6 To 25.40
Speed Rang	ROT/MIN	1.6 TO 16	0.6 To 6	0.5 To 5
Power	WATTS	25	25	25
Cable Length	MTR	8	8	8

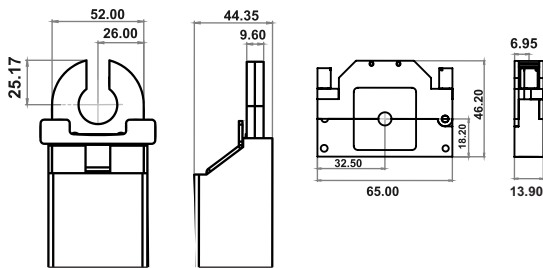

MH12_Assembly dwg

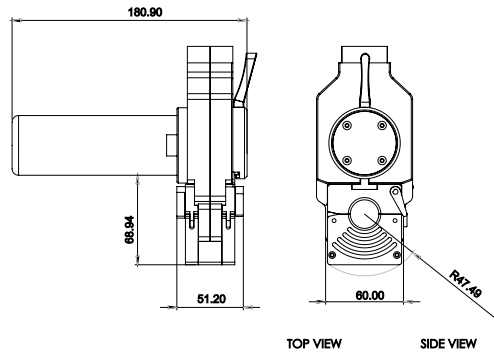

MH16_Assembly dwg

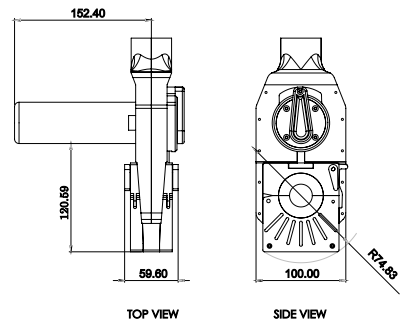

MH25_Assembly dwg

MH-25 X Weld Head

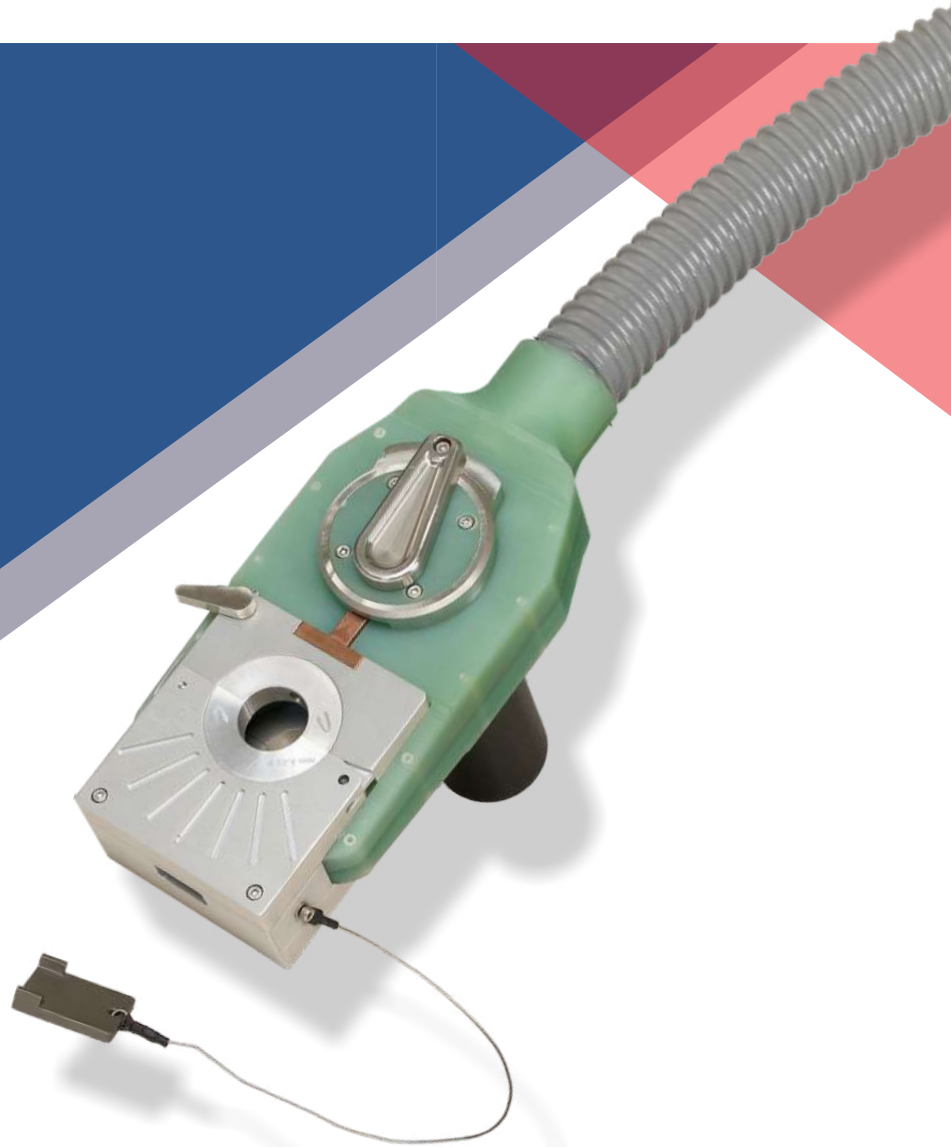

**UNIVERSAL
ORBITAL
SYSTEMS
PVT. LTD.**

S.No.29/8,29/9, Near Shree Control Chowk, Beside
Anant Industrial Estate Phase-3,
Narhe Dhayari Road,Pune,
Maharashtra- 411041 T: +918793089870 / 71 M:+918080288688
Email : sales@universalorbital.com / www.universalorbital.com



Due To Continuous Development, product Specification Are Subject To Change